

**LUMINAIRE MOUNTING ASSEMBLY  
TYPE V**

SCALE: 1/2" = 1'-0"

**NOTES:**

- LUMINAIRE MOUNTING ASSEMBLY DETAILS SHOWN SHALL BE USED FOR STEEL AND ALUMINUM LIGHTING STANDARDS.
- LUMINAIRE MOUNTING ASSEMBLY FOR ALUMINUM LIGHTING STANDARD SHALL BE MADE OUT OF ALLOY 6061-T6 MATERIAL TO MATCH LIGHTING STANDARD MATERIAL.
- LUMINAIRE MOUNTING ASSEMBLY FOR STEEL LIGHTING STANDARD SHALL BE MADE OUT OF ASTM A572, GR. 55 OR 65 MATERIAL TO MATCH LIGHTING STANDARD MATERIAL.
- LUMINAIRE MOUNTING ASSEMBLY INNER AND OUTER DIAMETER SHALL BE SIZED BASED ON THE LIGHTING STANDARD POLE OUTER DIAMETER.
- TWIN AND TRIPLE LUMINAIRES ARMS SHALL BE 180° AWAY FROM EACH OTHER.
- LUMINAIRE MOUNTING ASSEMBLIES SHALL BE FASTENED TO POLE SHAFT WITH HARDWARE AS SHOWN BELOW:  
TYPE V  
- (3) 3/8" - 16NC X 1" LONG SQ. HEAD CAP POINT, SET SCREWS  
- (3) 3/8" - 16NC JAM NUTS  
TYPE V2 AND V3  
- (2) 1/2" - 13NC X 8" LONG STUDBOLT  
- (4) 1/2" - 13NC JAM NUTS  
- (4) 1/2" LOCKWASHER, FLATWASHER, AND SCREWS
- NOT ALL LUMINAIRES MAY BE MOUNTED ON VERTICAL ADAPTORS. SEE SPECIFIC MANUFACTURER MOUNTING DIRECTIONS FOR OPTIONS.
- ALL HARDWARE SHALL BE STAINLESS STEEL GRADE 304 OR BETTER, UNLESS OTHERWISE NOTED.

9. THE CONTRACTOR SHALL BE RESPONSIBLE FOR FIELD INSPECTION OF ALL POLES TO ENSURE EACH MOUNTING ADAPTER IS THE CORRECT TYPE AND SIZE, AND IS MOUNTED IN THE APPROPRIATE METHOD FOR EACH LIGHT POLE.

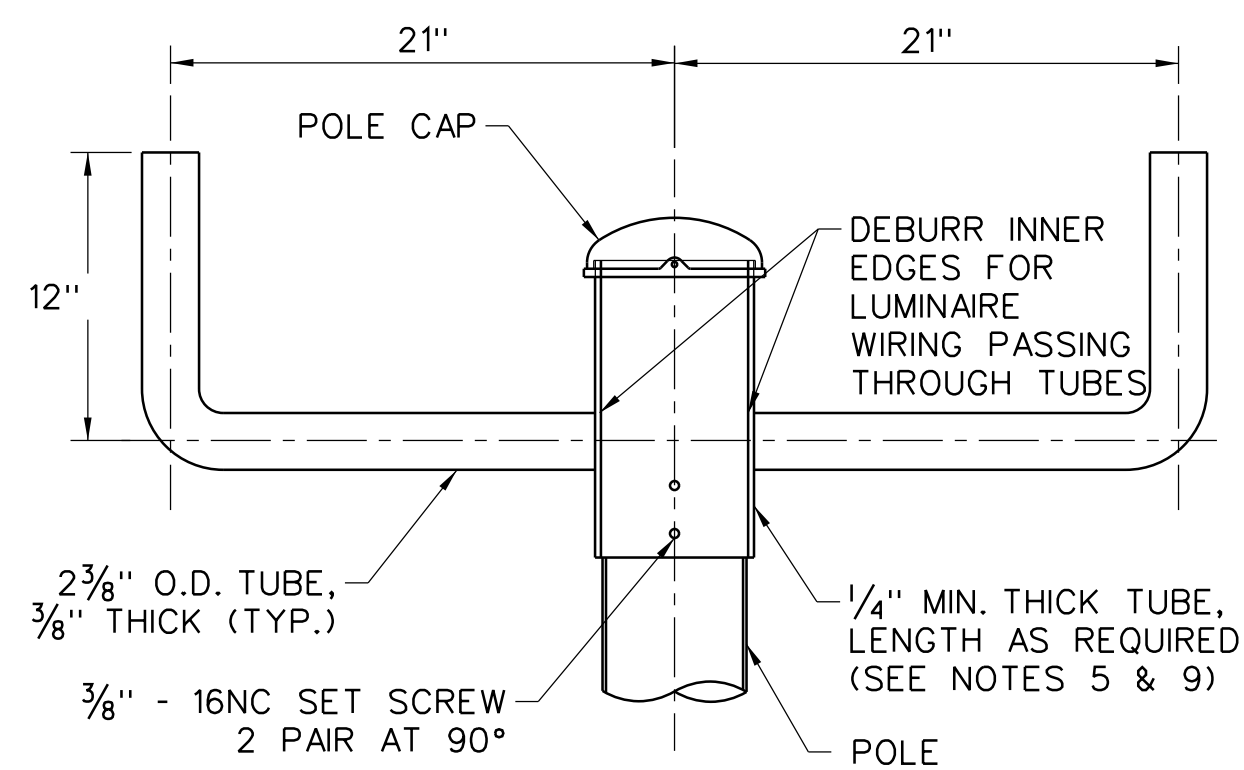

**LUMINAIRE MOUNTING ASSEMBLY  
TYPE V2**

SCALE: 1/2" = 1'-0"

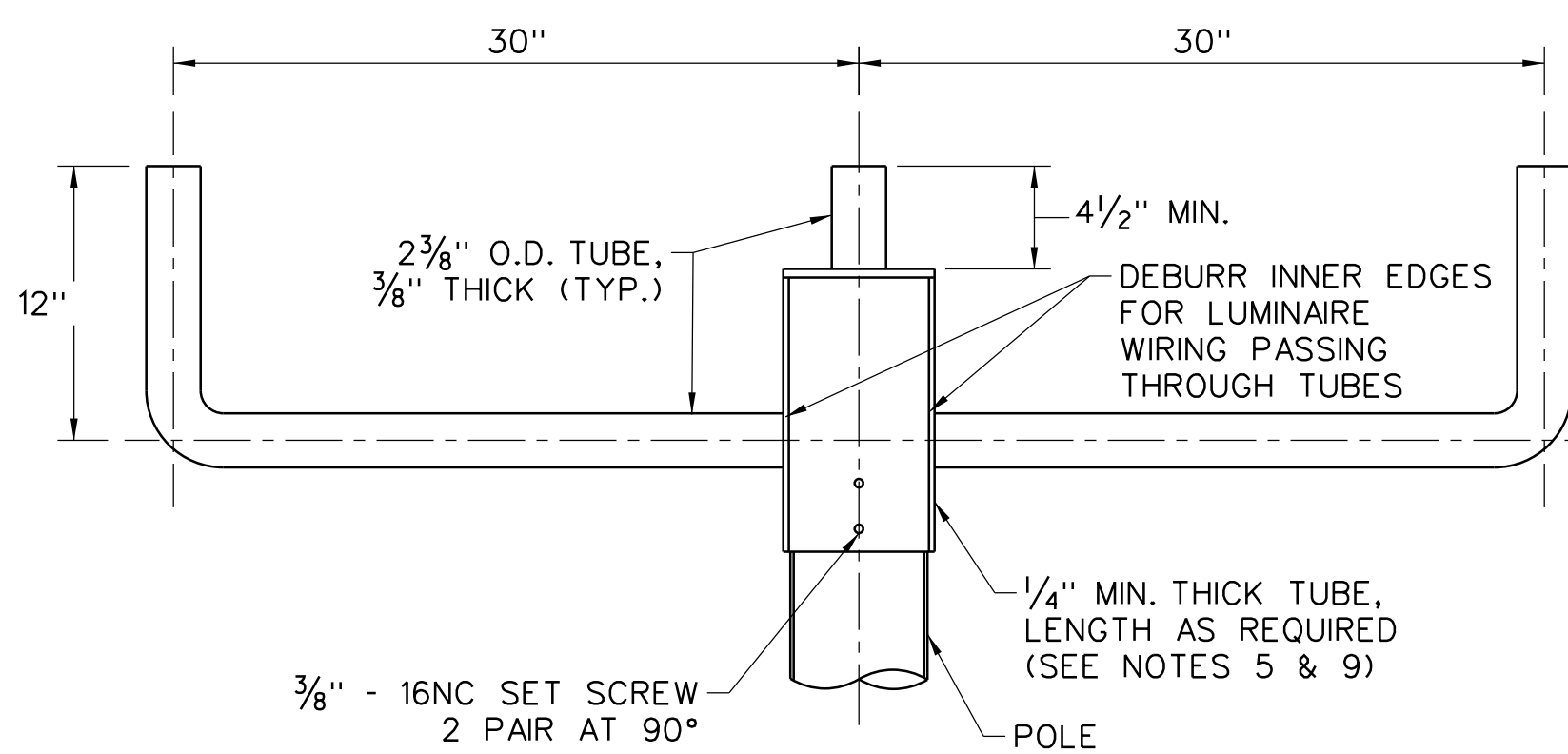

**LUMINAIRE MOUNTING ASSEMBLY  
TYPE V3**

SCALE: 1/2" = 1'-0"

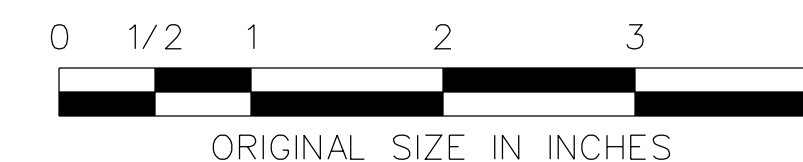

NEW JERSEY TURNPIKE AUTHORITY  
**NEW JERSEY TURNPIKE  
GARDEN STATE PARKWAY**

STANDARD DRAWINGS

**TYPE V POLE-TOP LUMINAIRE  
MOUNTING ASSEMBLIES**

OFFICE OF THE CHIEF ENGINEER  
NEW JERSEY TURNPIKE AUTHORITY  
WOODBIDGE, NEW JERSEY

STANDARD DRAWING

REV.	DESCRIPTION	DATE
1	ADDED NOTE	01/24
0	REISSUED DRAWING	09/21

E-05